

**1845050**

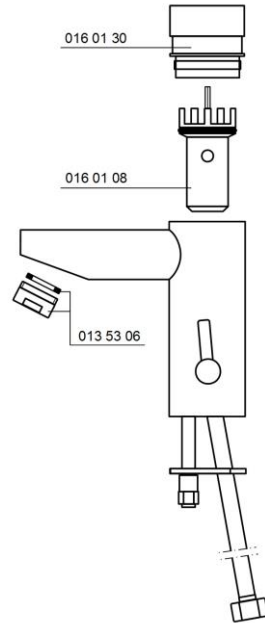

Druckknopf lösen, mit Inbus-Schlüssel  
Unfasten the push-button with Allen Key

Laufzeit einstellen  
Set timing

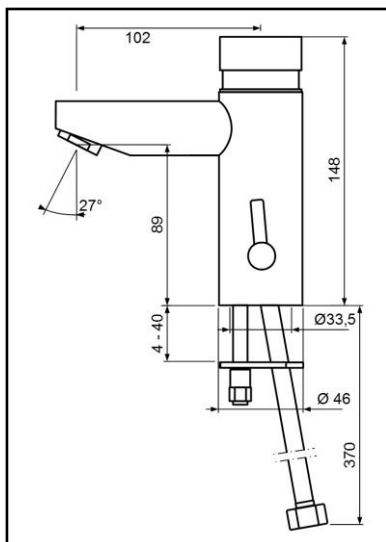

**Wichtige Zubehöre und Ersatzteile**  
Most Important Accessories and Spare Parts

 <p>Flex. Schlauch mit RV M10 x 1 Art. 016 02 15</p>	 <p>Mischhebel Art. 061 02 30</p>	 <p>Perlator 6 L/Min. Art. 013 53 06</p>	 <p>Stiftschraube Art. 600 22 05</p>	 <p>Filter-Eck-Ventil Art. 788 38 12</p>
 <p>Kappenschlüssel Art. 600 22 06</p>	 <p>Druckknopf-garnitur kpl. Art. 016 01 30</p>	 <p>Kartusche Art. 016 01 08</p>		

## Montagevorbereitung

### Preparation of installation

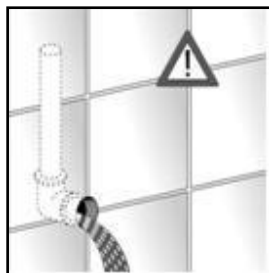

Wasserleitung spülen  
Flush the water supply-line

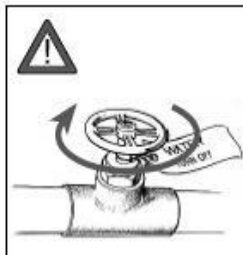

Wasserhaupteahn absperren  
Close the main water-supply valve

## Wartung

### Service

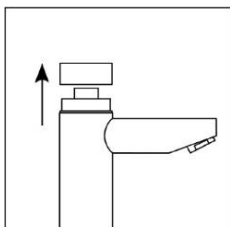

Druckknopf lösen  
Unfasten push-button

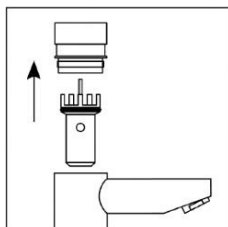

Kartusche entnehmen  
Take out the cartridge

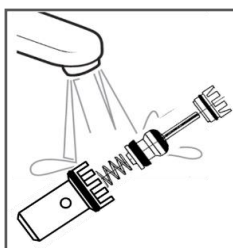

Bei zu langer Laufzeit: Kartusche  
innen mit Leitungswasser ausspülen  
In case of too long runtime: wash out  
the inside of the cartridge

## Pflege

### Maintenance

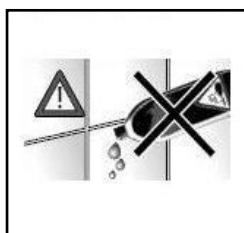

Keine scharfen Reinigungsmittel  
verwenden  
Do not use sharp detergent

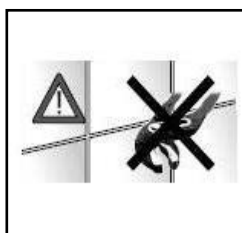

Keine Rohrzanze verwenden  
Do not use pipe tongs